

OVERHEAD RACK AND PINION “Viro zip” RANGE

- **Universal installation** for wooden or metal doors both right and left-hand. Can be installed
√ either on the door (standard installation).
√ or on the door jamb (reverse installation).
- **Hydraulic working:** does not require periodic oil change.
No maintenance required.
- **Body:** one piece painted pressure-cast aluminum.
- **Steel arm that allows a stroke of approximately 80 mm.** (from – 10 mm. to + 70 mm.)
- **Adjustable hold open: by means of an internal device.**
- The door can be manually blocked in any position between 90° and the maximum opening angle.
- **Regulating valves for closing speed and latching speed.**
- The valves can be easily reached from the outside, without removing the doorcloser.
- **Overload relief internal valve.**
- **Fixed strength versions:** .02 .03 .04

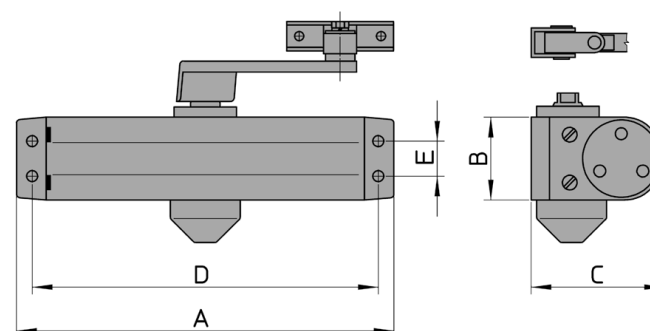

- **Supplied with :**
√ 2 installation templates for standard or top jamb application, for right and lefthand doors.
√ bag of screws (metric-thread screws for metal doors or self-tapping screws for wooden doors).



ITEM No.	Case Dimensions mm. A x B x C	Fixing Holes		Unit Weight g	Strength Size	Version	FOR DOORS	
		Horiz. D	Vert. E				Max. width cm.	Max.Weight Kg.
116.02.1	144 x 36,5 x 56	132	19	1180	2 - Fixed	non hold open	85	45
116.03.1	178 x 40 x 60	162	19	1380	3 - Fixed		95	65
116.04.1	184 x 41,5 x 67	168	24	1680	4 - Fixed		110	85
116.02.2	144 x 36,5 x 56	132	19	1180	2 - Fixed	with internal hold open	85	45
116.03.2	178 x 40 x 60	162	19	1380	3 - Fixed		95	65
116.04.2	184 x 41,5 x 67	168	24	1680	4 - Fixed		110	85